

**BEECHCRAFT
DUKE 60 SERIES
MAINTENANCE MANUAL**

**EXTENSION AND RETRACTION - MAINTENANCE
PRACTICES**

LUBRICATION

Lubricate the landing gear retract system as detailed in the Lubrication Chart in Chapter 12-20-00.

**LANDING GEAR MOTOR AND ACTUATOR
REMOVAL**

When it is necessary to remove only the landing gear motor, accomplish steps "a", "b", "g" and "m".

- a. Remove the cabin front seat.
- b. Remove the carpet and access covers on top and directly behind the front carry through structure.

CAUTION

When removing the actuator from the airplane, do not remove the actuator drive shaft from the actuator. The drive shaft is indexed to the sector gear and the actuator will have to be disassembled to reinstall the drive shaft.

- c. Disconnect the fuel selector valve controls and move them as far to one side as the cable slack will allow.
- d. Disconnect the main landing gear retract rods at the actuator.
- e. Disconnect the landing gear door retract rods at the actuator.
- f. Remove the screws securing the landing gear limit switch assembly(ies) to the actuator and move the switch assembly(ies) aside to permit removal of the actuator.

NOTE

On serials P-139 and after, there are two switch assemblies, one on each side of the actuator.

- g. Disconnect electrical wiring from the landing gear motor and the dynamic brake relay.
- h. Remove the landing gear actuator access door on the bottom of the fuselage, and remove the nose gear actuator retract arm and linkage from the actuator.
- i. Through the actuator access opening, remove the four nuts attaching the actuator to the fuselage structure.

- j. Remove the landing gear actuator upper support retaining nut.
- k. Remove the screws securing the upper support plate to its cross member.
- l. Remove the landing gear actuator. The cross member may have to be moved upward to gain clearance as the actuator is lifted to clear its attaching studs.
- m. Remove the three bolts attaching the landing gear motor to the actuator.

**LANDING GEAR MOTOR AND ACTUATOR
INSTALLATION**

If only the landing gear motor has been removed, accomplish steps "a", "g", "j" and "k".

- a. Install the three bolts attaching the landing gear motor to the actuator and secure with safety wire.
- b. Position the actuator against the fuselage structure and install the four attaching bolts.

NOTE

Prior to installing the actuator nuts, apply thread locking compound (36, Chart 207, 91-00-00) to the actuator stud threads.

- c. Install the upper support plate to the cross member.
- d. Install the actuator upper support retaining nut.
- e. Secure the landing gear limit switch assembly(ies) to the actuator.
- f. Connect the main landing gear retract rods and door retract rods to the actuator. An AN960-616 washer is installed between the main gear retract rods and the actuator arm.
- g. Connect the electrical wiring to the landing gear motor and the dynamic brake relay.
- h. Connect the fuel selector valve control and check rigging. (Refer to Chapter 28-20-00).
- i. Connect the nose landing gear rod and linkage to the actuator.

NOTE

When connecting the nose gear retract rod to the actuator, make certain the index mark on the arm and the actuator shaft coincide.

Check rigging of the landing gear system. When

BEECHCRAFT
DUKE 60 SERIES
MAINTENANCE MANUAL

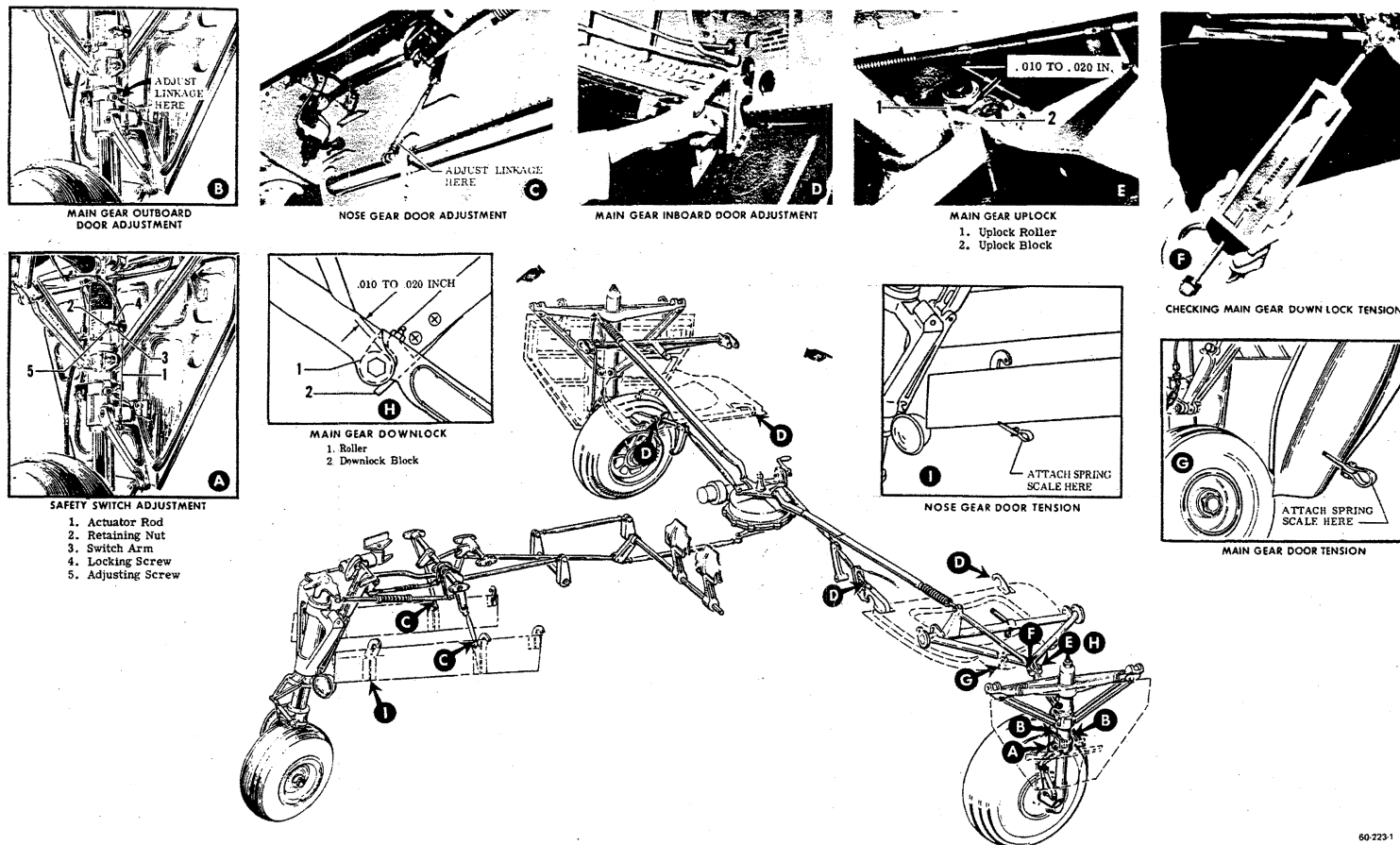

60-223-1

Landing Gear System
Figure 201